

Round Mate Vertically Expandable “EX” Series

Single & Multi Position

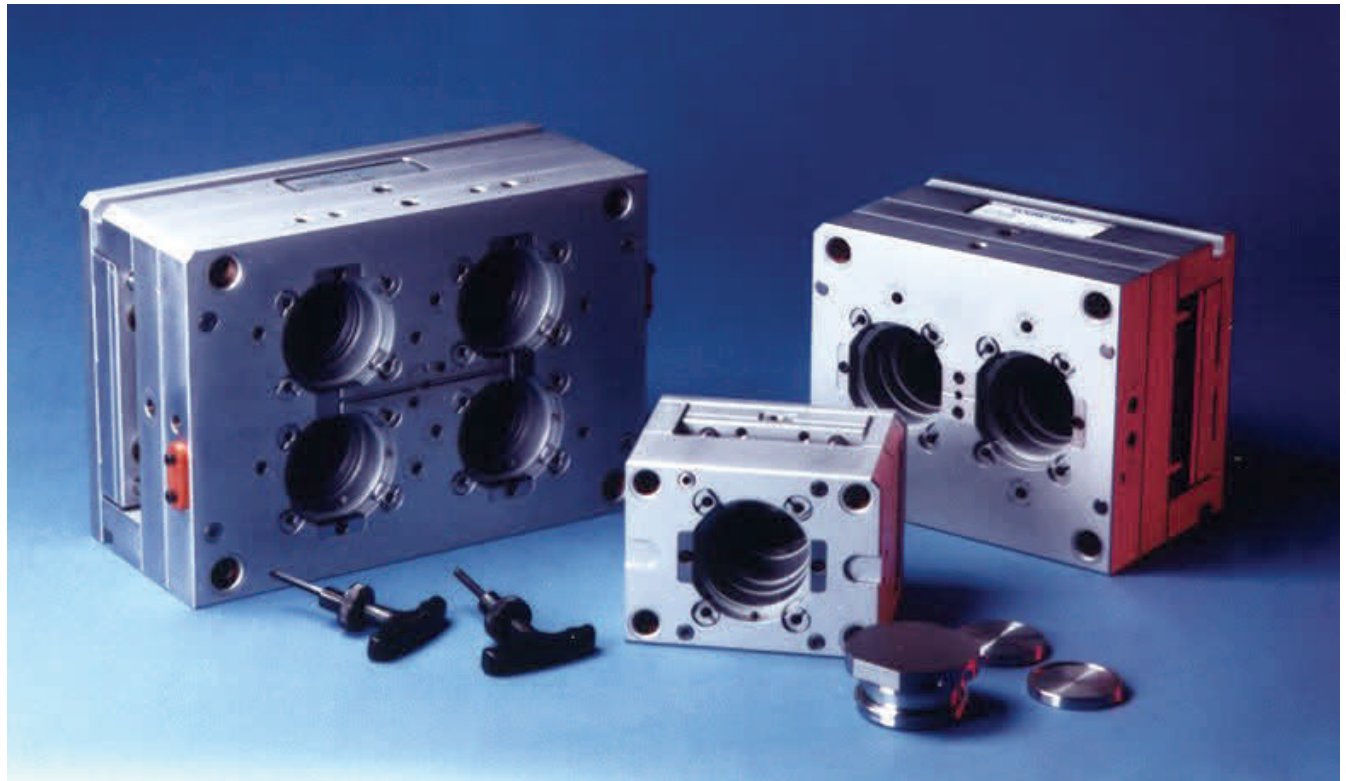

Revision: 2/2012

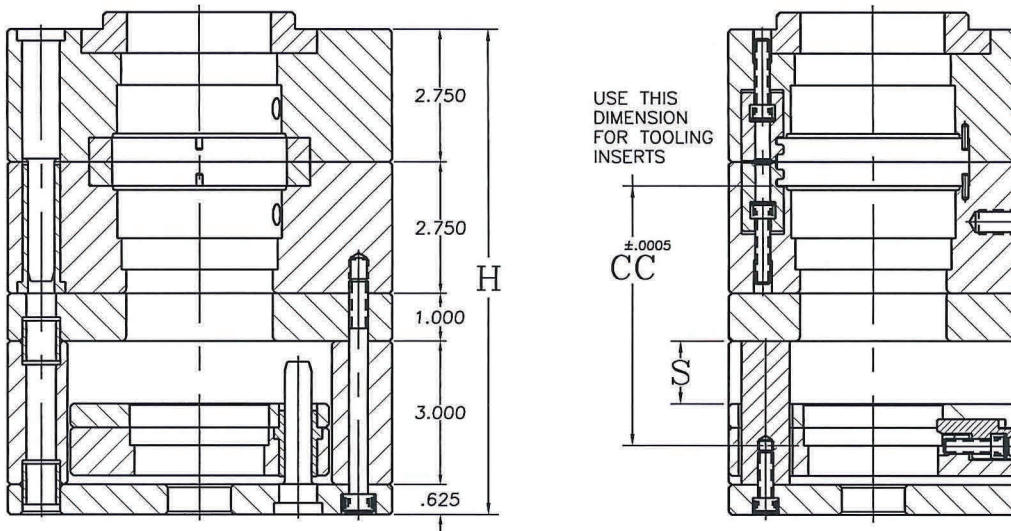
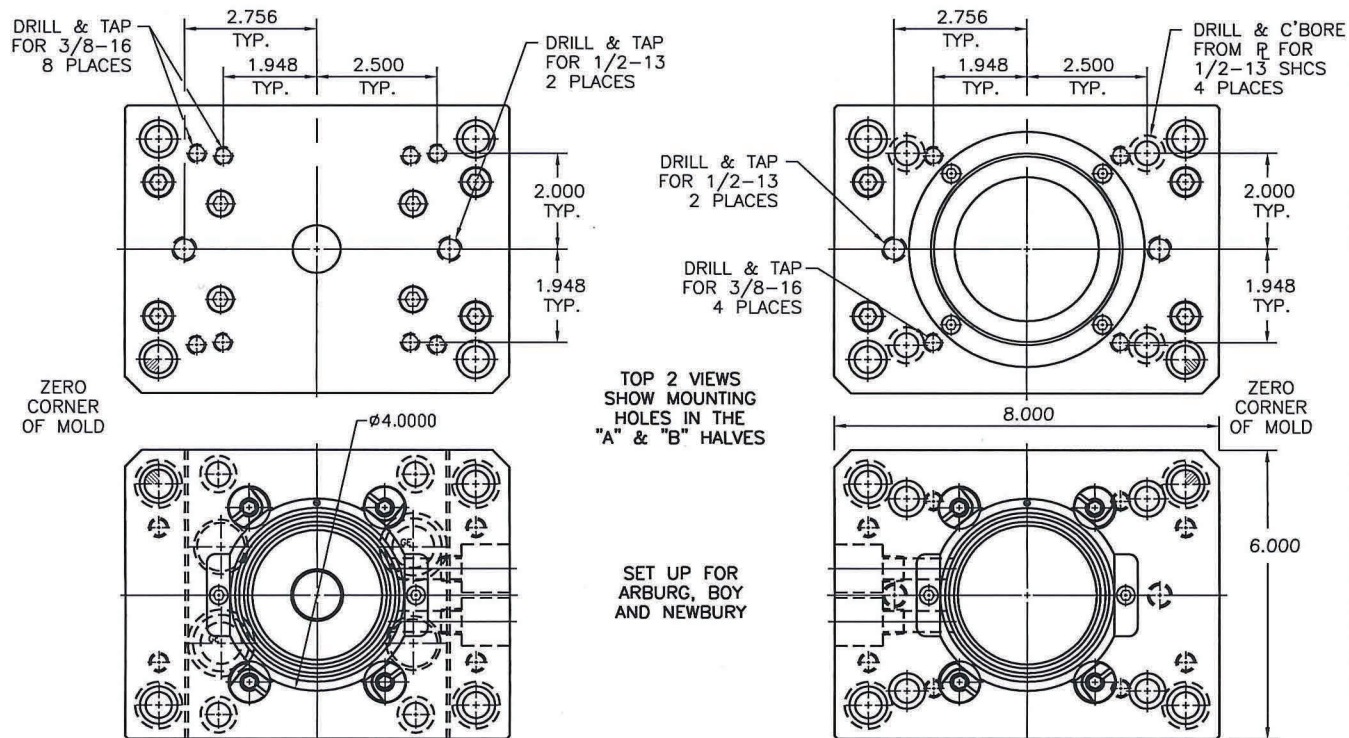

STANDARD MASTER FRAME

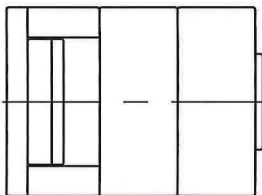

STYLE #	C	CC	H	S
RMF-0413-X	3.00	5.4375	10.125	1.312

4" EX1 Frame Components

ROUND MATE®

LOCATING RING

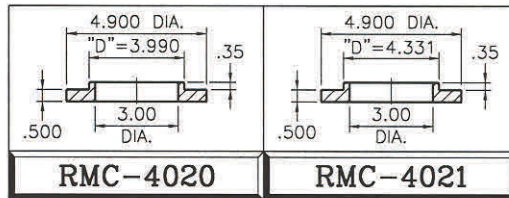
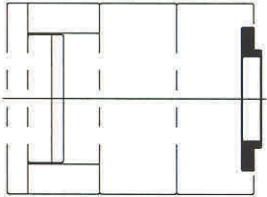

MOUNTING SCREWS INCLUDED

MAT'L 4140

RETAINER/LIFTER - EJECTOR RETAINER WRENCH

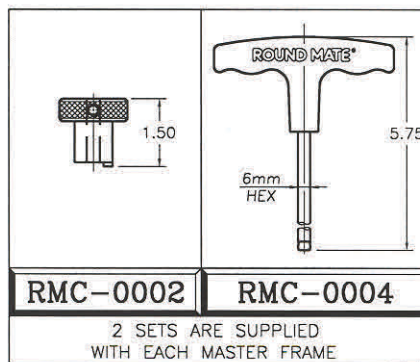

ZERO CORNER
OF MOLD

ZERO FLATS
OF INSERTS

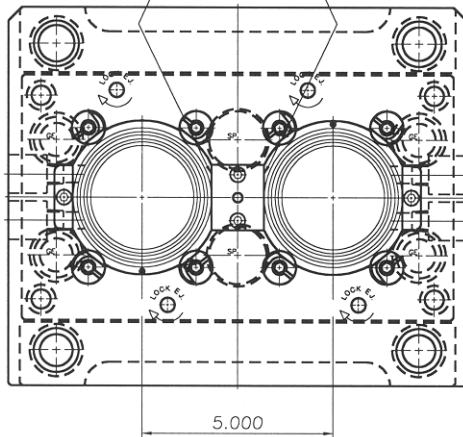

Ø4.0000

ZERO CORNER
OF MOLD

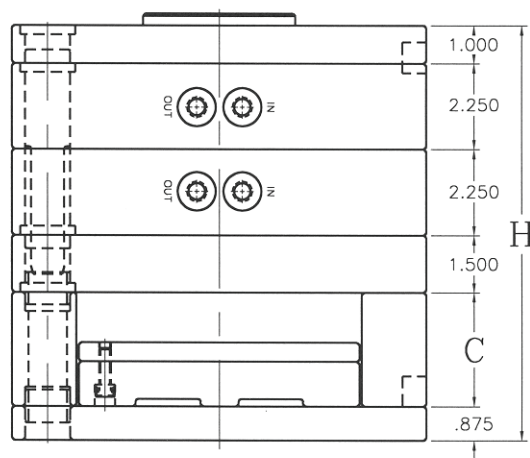
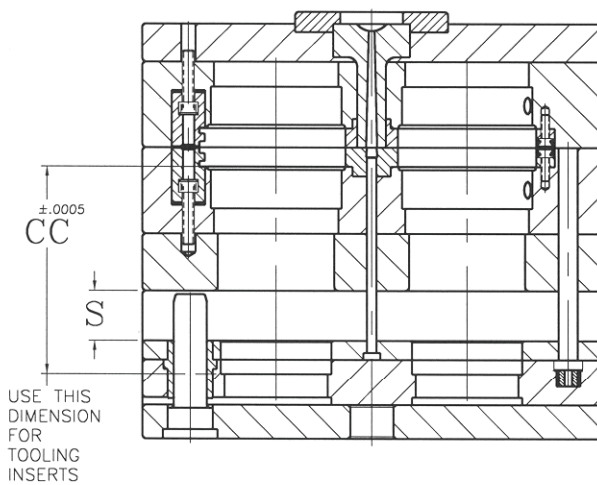
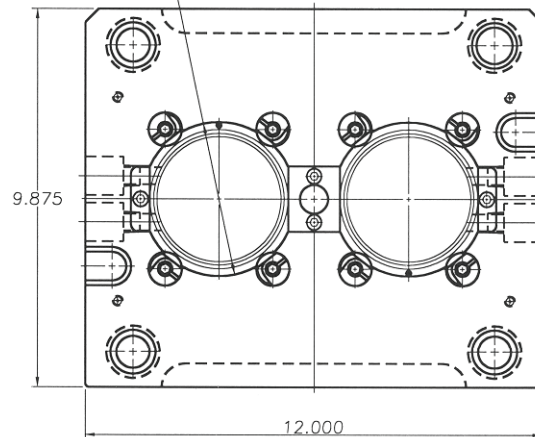

MULTI-POSITION MASTER FRAMES ARE SUPPLIED WITH SPI STANDARD KNOCKOUT LOCATIONS.
NON-STANDARD KNOCKOUT LOCATIONS WILL BE QUOTED UPON REQUEST.

WHEN ORDERING A MULTI-POSITION MASTER FRAME PLEASE SPECIFY: RUNNER SIZE;
RUNNER BLOCK HEIGHT; SPRUE BUSHING "R" & "O" DIM.; LOCATING RING TYP

STANDARD TWO POSITION MASTER FRAME

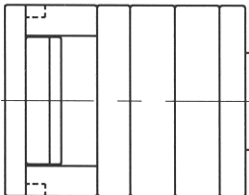

STYLE #	C	CC	H	S
RMF-0423	3	5.4375	10.875	1.312
RMF-0424	4	6.4375	11.875	2.312
RMF-0425	5	7.4375	12.875	3.312

4" EX2 Frame Components

ROUND MATE®

INSULATOR BOARD

OPTIONAL

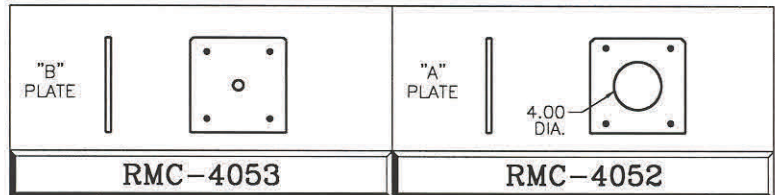
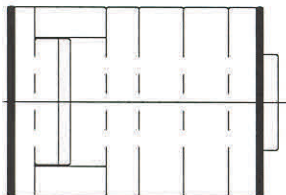

EXTENDED LOCATING RING

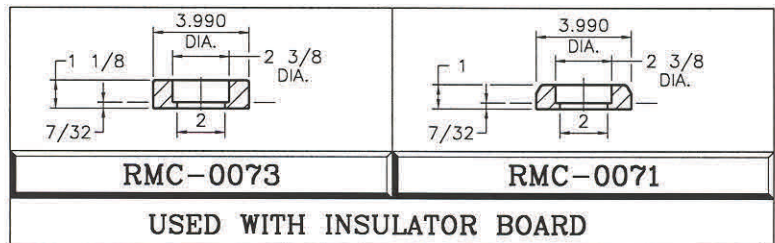
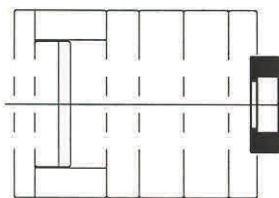

LOCATING RING

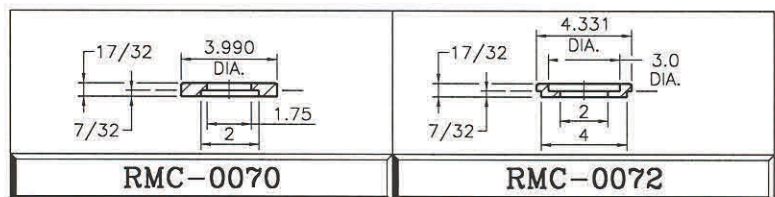
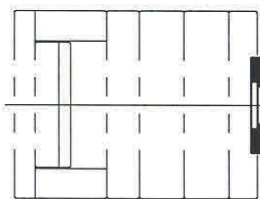

RETAINER/LIFTER

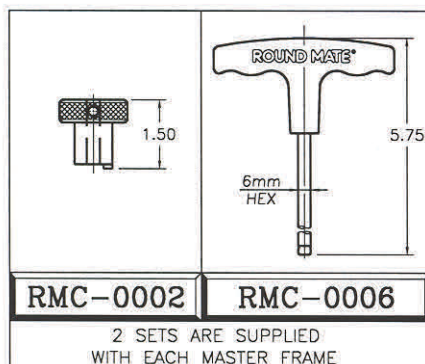

EJECTOR RETAINER WRENCH

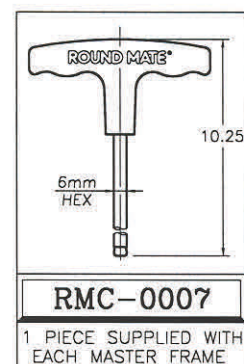

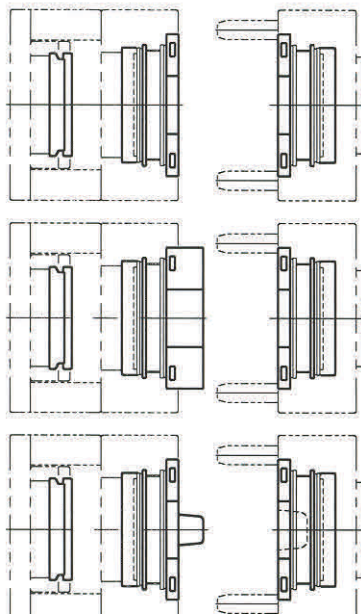

MULTI POSITION MASTER FRAMES CAN NOT USE EXTENDED PARTING LINE ON INSERTS

STANDARD "A" & "B"

STANDARD "A" STAND-UP "B" USED FOR EXTENDED PARTING LINE

STANDARD "A" STAND-UP "B" USED FOR CORE OR INTERLOCKING

WATER DAM AND SAFETY STRAP INCLUDED
CORE PLATES ARE REQUIRED

STANDARD INSERT

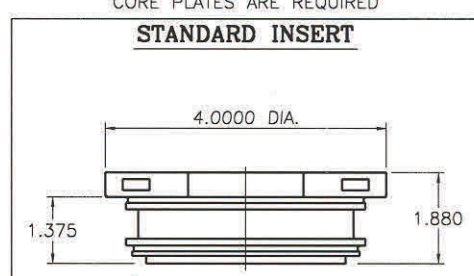

RMI-4*19

* ADD STEEL CODE TO COMPLETE CATALOG NUMBER

WATER DAM AND SAFETY STRAP INCLUDED
CORE PLATES ARE REQUIRED

.100 STAND-UP

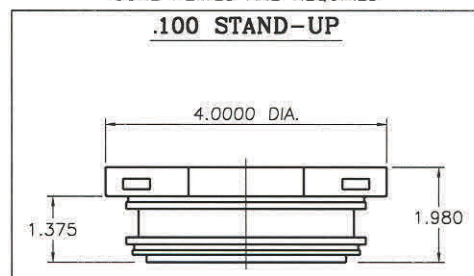

RMI-4*20

* ADD STEEL CODE TO COMPLETE CATALOG NUMBER

WATER DAM AND SAFETY STRAP INCLUDED
CORE PLATES ARE REQUIRED

.500 STAND-UP

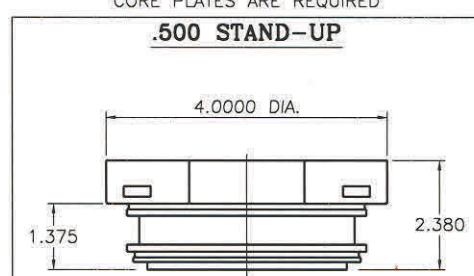

RMI-4*24

* ADD STEEL CODE TO COMPLETE CATALOG NUMBER

WATER DAM AND SAFETY STRAP INCLUDED
CORE PLATES ARE REQUIRED

1.000 STAND-UP

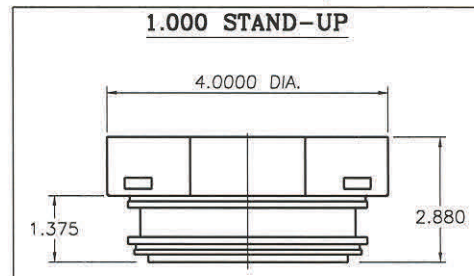

RMI-4*29

* ADD STEEL CODE TO COMPLETE CATALOG NUMBER

AVAILABLE STEEL

* CODE	STEEL
3	P-20 PRE-HARD 32/34 Rc
4	S-7 ANNEALED
5	H-13 ANNEALED
6	420SS ANNEALED
8	420SS PRE-HARD 32/35 Rc

* USE CODE NUMBER ABOVE TO COMPLETE CATALOG NUMBER FOR INSERTS.

GRIND STOCK



H-13, S-7 & 420SS HEAT TREATABLE INSERTS HAVE .005 GRIND STOCK LEFT ON SURFACES SHOWN FOR GRIND AFTER HEAT TREAT

4" EX Insert Components

CORE RETAINER PLATE

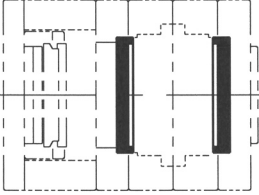
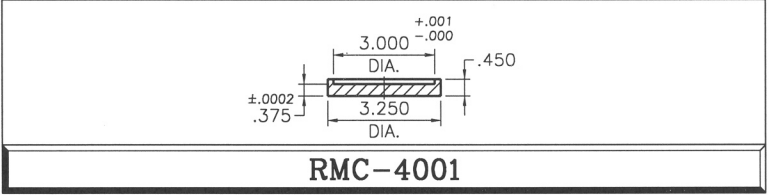
RMC-4001

NOTE: MUST ALWAYS BE USED WITH INSERT. MAT'L 4140

EJECTOR PLATE ASSEMBLY



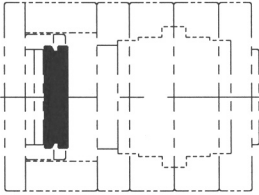
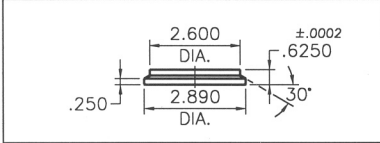
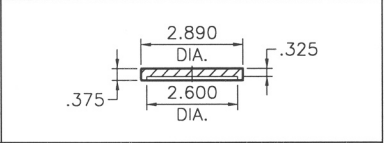

RMC-4003 **RMC-4002**

EJECTOR PLATE EJECTOR RETAINER PLATE MAT'L 4140

QUICK CONNECT EJECTOR PLATE

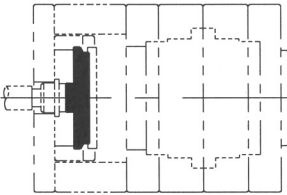
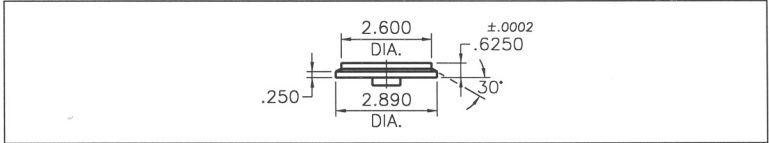
OPTIONAL

RMC-4006

FOR USE WITH **SINGLE POSITION** MASTER FRAME MAT'L 4140

QUICK EJECTOR CONNECT

1/2-13 MALE END

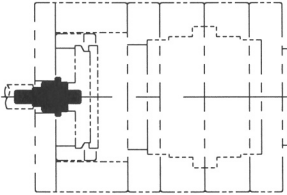
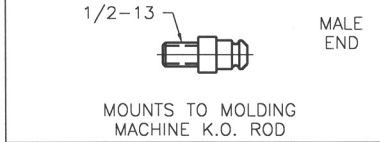
MOUNTS TO MOLDING MACHINE K.O. ROD

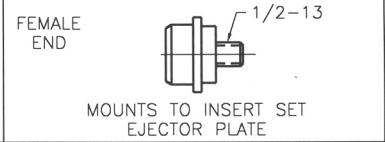

1/2-13 FEMALE END

MOUNTS TO INSERT SET EJECTOR PLATE

RMC-0015 **RMC-0016**

SLEEVE EJECTION CORE RETAINER PLATES

OPTIONAL

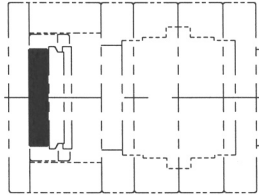
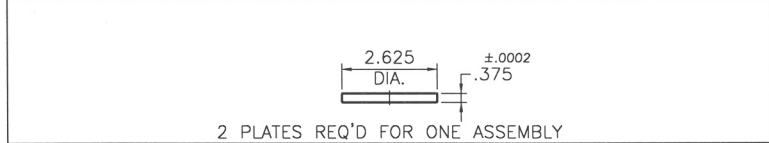





2 PLATES REQ'D FOR ONE ASSEMBLY

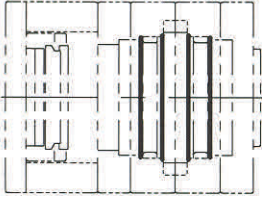

RMC-4004

MAT'L 4140

O-RINGS



O-RING SET FOR 4" INSERT		SET INCLUDES 2 O-RINGS FOR ONE INSERT	O-RING SET FOR 4" INSERT		SET INCLUDES 2 O-RINGS FOR ONE INSERT
RMC-4015			RMC-4017		
2 SETS ARE INCLUDED WITH INSERT SET			ARE AVAILABLE UPON REQUEST		

O-RING SET FOR 4" INSERT		PACKAGE OF 10 O-RING SETS	O-RING SET FOR 4" INSERT		PACKAGE OF 4 O-RING SETS
RMC-4016			RMC-4018		
ARE AVAILABLE UPON REQUEST			ARE AVAILABLE UPON REQUEST		

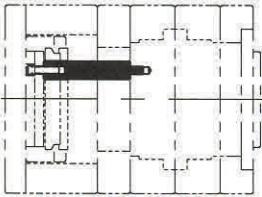

SLEEVE EJECTION SUPPORT PILLAR

OPTIONAL



MOLD MAKER MAY TRIM SUPPORT PILLARS TO LENGTH FOR CUSTOM APPLICATIONS

SET SCREW INCLUDED

	5/16-18 L ±.0005		5/16-18 L ±.0005
"L"=2.7520		"L"=5.1270	
RMC-0020		RMC-0025	
"L"=3.7520		"L"=6.1270	
RMC-0021		RMC-0027	

MAT'L 1144

WATER BAFFLE (Packs of 10)

NYLON PLASTIC, NOT FOR HIGH TEMPERATURE APPLICATIONS

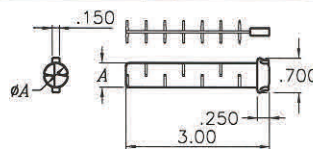
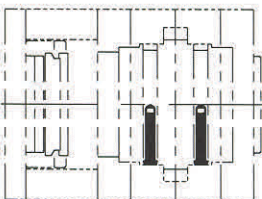

A DIM.	FOR USE WITH 3", 4" AND 6" ROUND MATE INSERTS
.312	RMC-0080
.500	RMC-0081

4" EX Insert Components

ROUND MATE®

WATER DAM

1 SUPPLIED WITH EACH INSERT

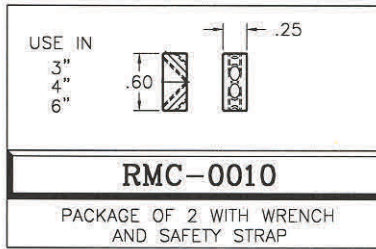
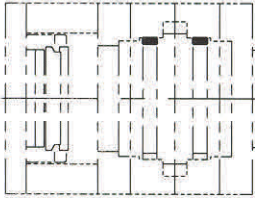

PACKAGE OF 2 WITH WRENCH AND SAFETY STRAP

MAT'L 416SS

SAFETY STRAP

1 SUPPLIED WITH EACH INSERT

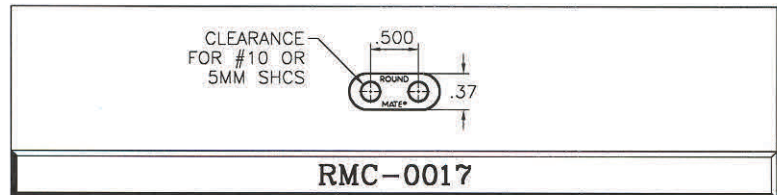
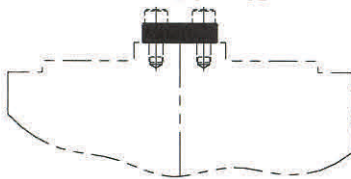

PACKAGE OF 10

MAT'L NYLON

RETURN PIN EXTENSIONS

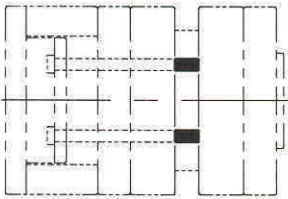

OPTIONAL

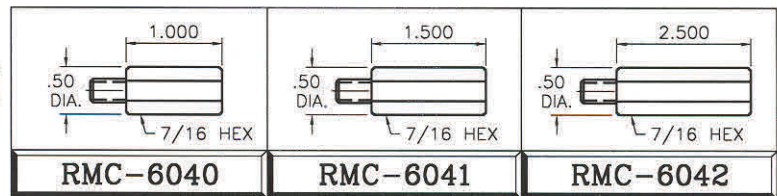

MAT'L 4142

FITTED STORAGE BOX

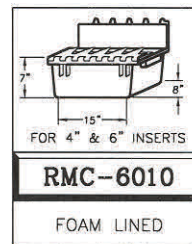
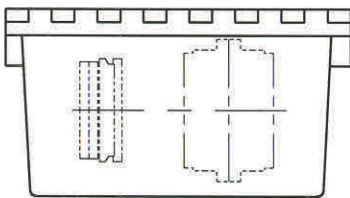

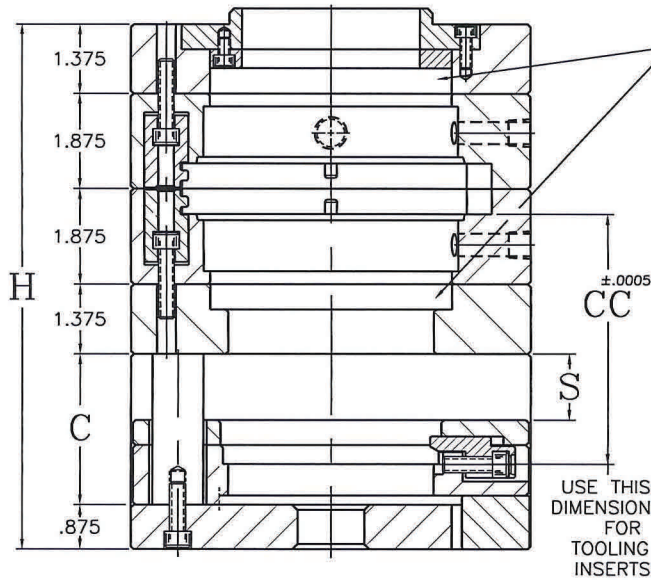
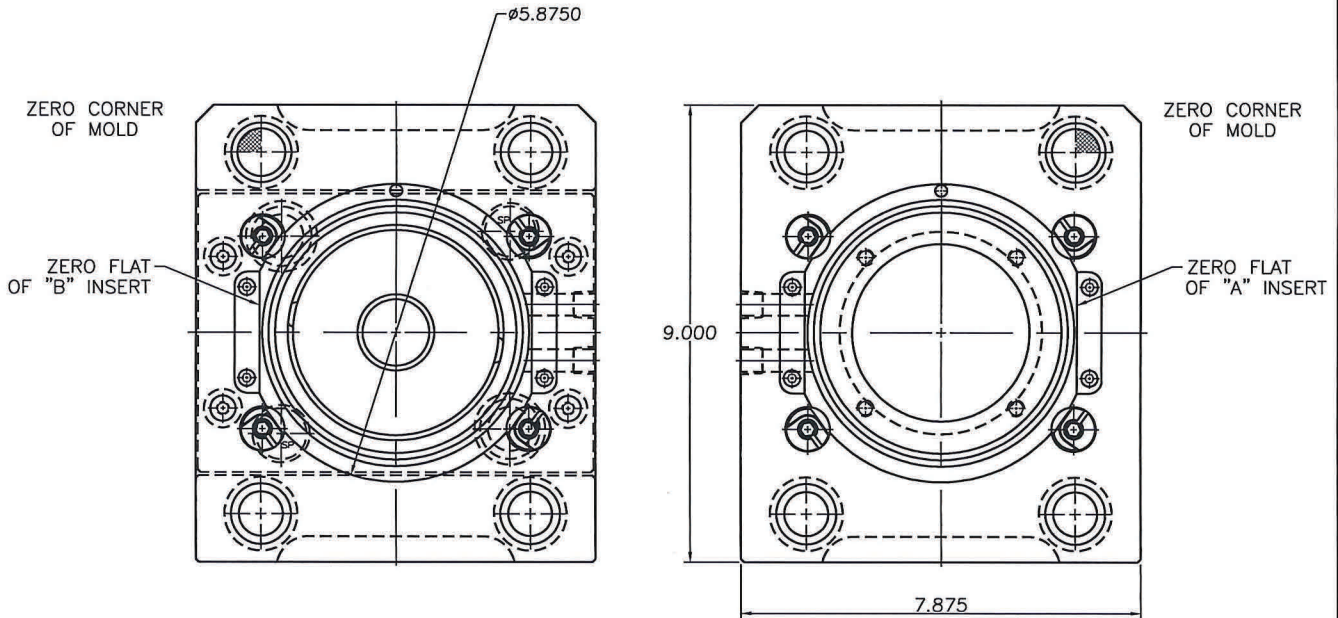

NOTE: THE EX OPTION WAS CREATED TO MAKE THE INSERT SET EXPANDABLE TO THE MULTI POSITION MASTER FRAME. THE MULTI POSITION MASTER FRAME REQUIRES CORE RETAINER PLATES ON THE BACK OF BOTH INSERTS. THIS EX OPTION ALLOWS SINGLE POSITION INSERT SETS TO BE VERTICALLY EXPANDABLE TO THE MULTI POSITION MASTER FRAMES BY UTILIZING THE ADDITIONAL CORE RETAINER PLATES.

STANDARD MASTER FRAME WITH EXPANDABLE OPTION (EX)

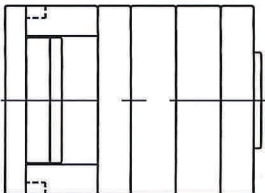

STYLE #	C	CC	H	S
RMF-0613-X	3	4.9375	10.375	1.312
RMF-0614-X	4	5.9375	11.375	2.312

6" EX1 Frame Components

ROUND MATE®

INSULATOR BOARD

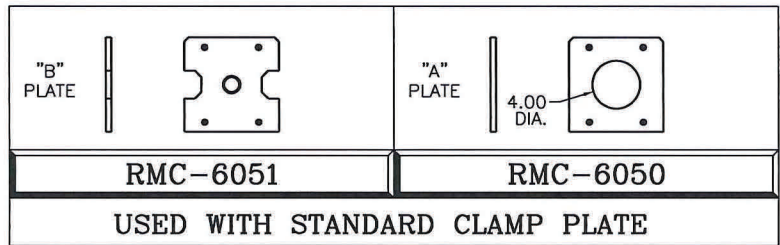
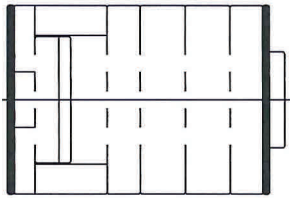

OPTIONAL

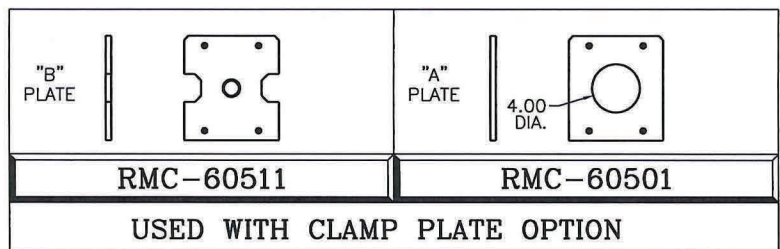
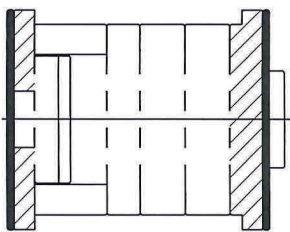

EXTENDED LOCATING RING

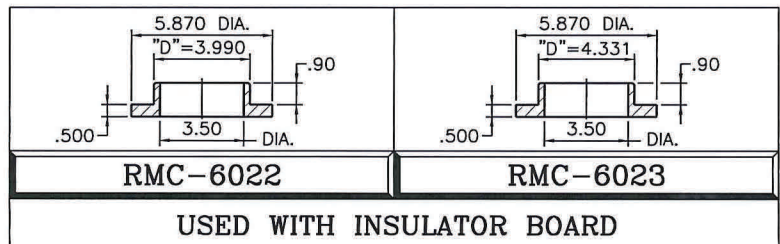
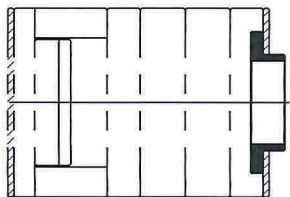

MOUNTING SCREWS INCLUDED

MAT'L 4140

LOCATING RING

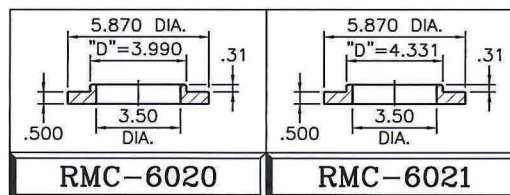
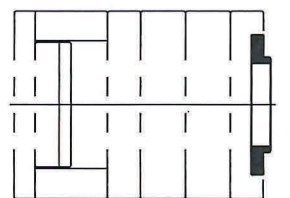

MOUNTING SCREWS INCLUDED

EXTENDED NOZZLE DISC

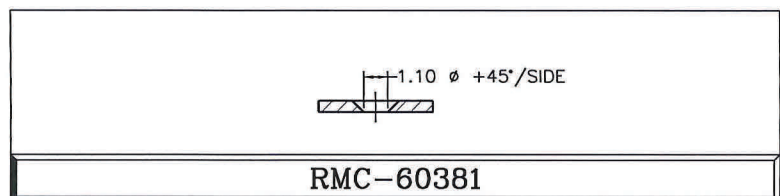
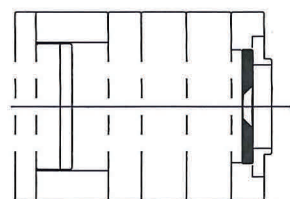

MOUNTING SCREWS INCLUDED

MAT'L 6150 H.T.

6" EX1 Frame Components

EJECTOR K.O. MOUNTING BLOCK

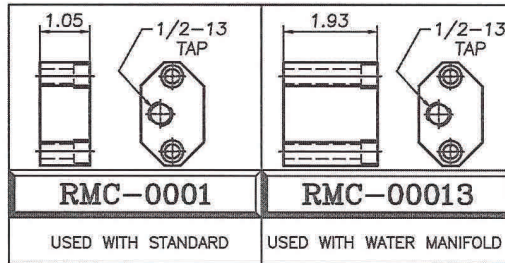
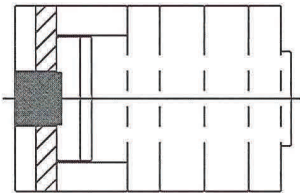
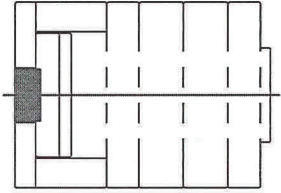

PACKAGE OF 2 2 K.O. BLOCKS INCLUDED WITH MASTER FRAME MAT'L 4140

RETAINER/LIFTER - EJECTOR RETAINER WRENCH

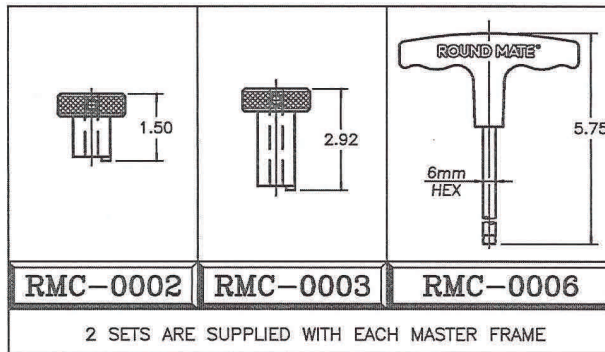

ROUND MATE®

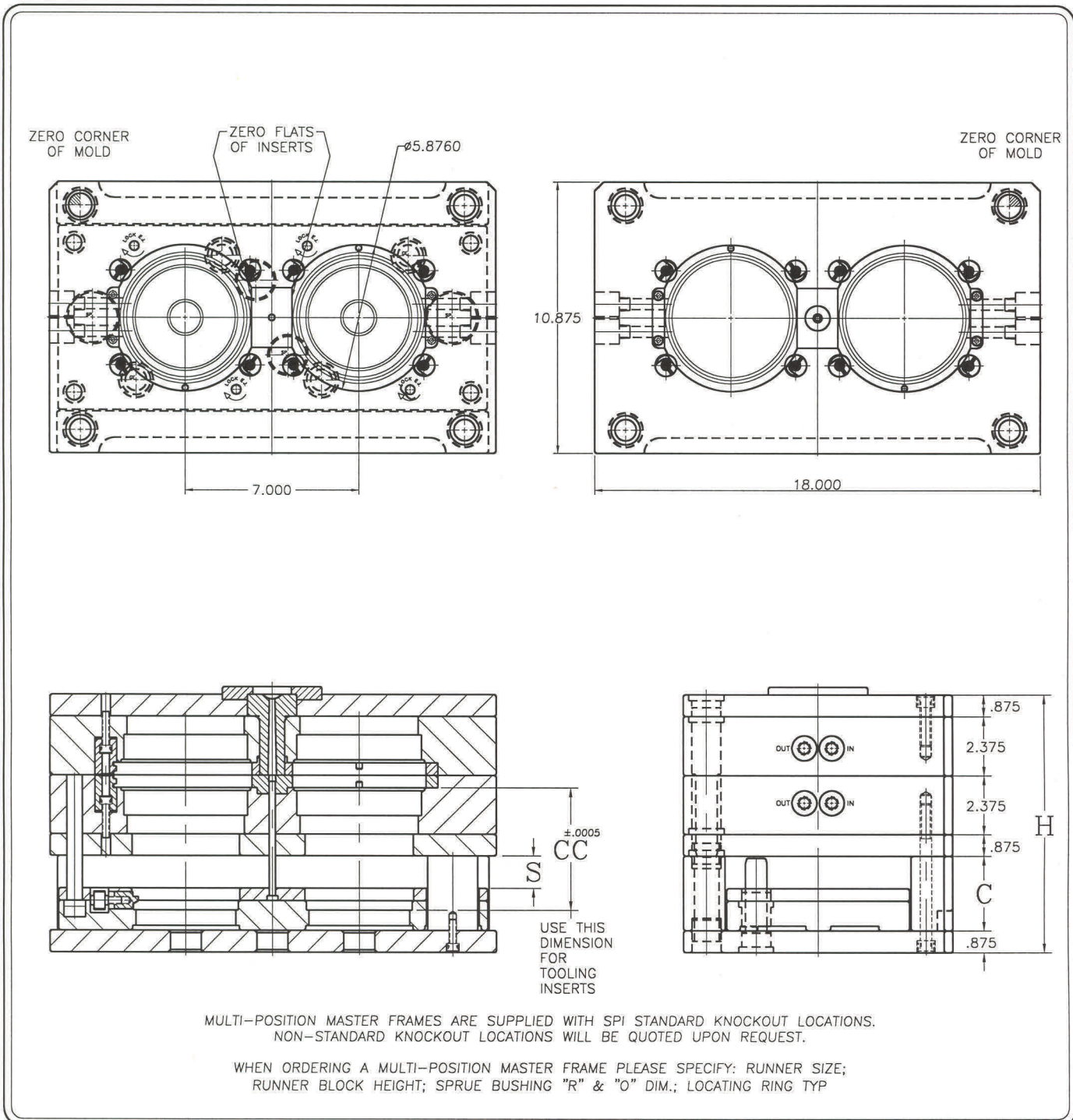

STANDARD 2 POSITION MASTER FRAME

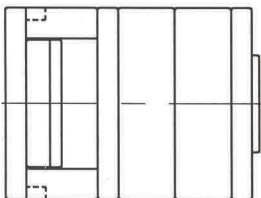

STYLE #	C	CC	H	S
RMF-0623	3	4.9375	10.375	1.312
RMF-0624	4	5.9375	11.375	2.312
RMF-0625	5	6.9375	12.375	3.312

6" EX2 Frame Components

ROUND MATE®

INSULATOR BOARD OPTIONAL

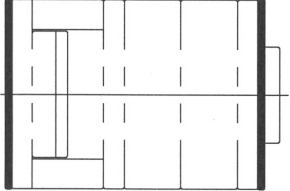

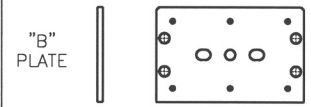
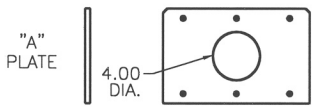
 <p>"B" PLATE</p>	 <p>"A" PLATE 4.00 DIA.</p>
RMC-6053	RMC-6052
USED WITH STANDARD CLAMP PLATE	

EXTENDED LOCATING RING

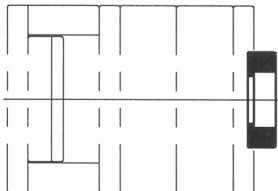

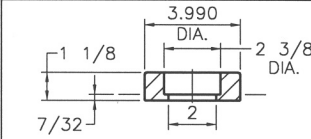
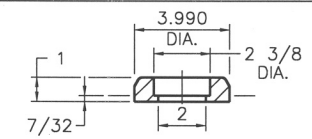
	
RMC-0073	RMC-0071
USED WITH INSULATOR BOARD	

LOCATING RING

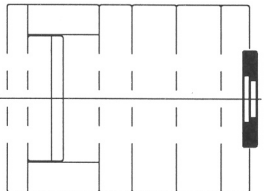

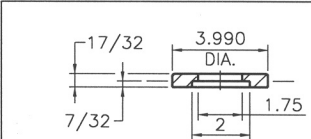
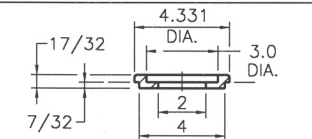
	
RMC-0070	RMC-0072

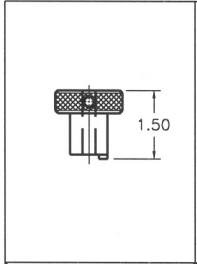
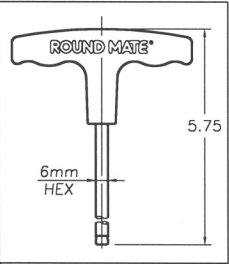
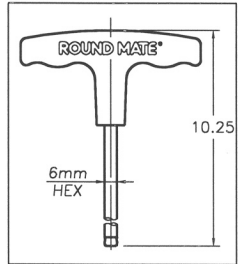
<p>RETAINER/LIFTER</p>  <p style="text-align: center;">RMC-0002</p>	<p>RETAINER/LIFTER</p>  <p style="text-align: center;">RMC-0006</p>	<p>EJECTOR RETAINER WRENCH</p>  <p style="text-align: center;">RMC-0007</p>
<p>2 SETS ARE SUPPLIED WITH EACH MASTER FRAME</p>		<p>1 PIECE SUPPLIED WITH EACH MASTER FRAME</p>

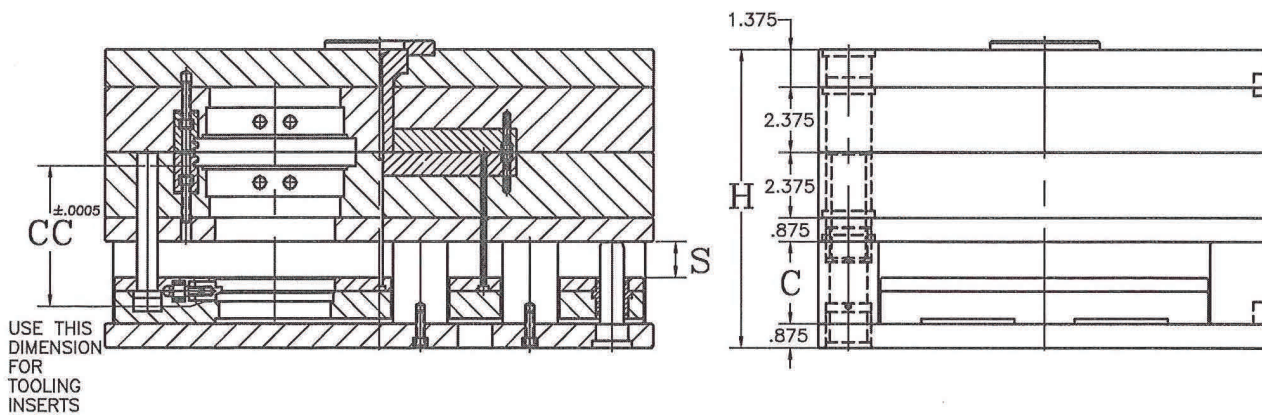
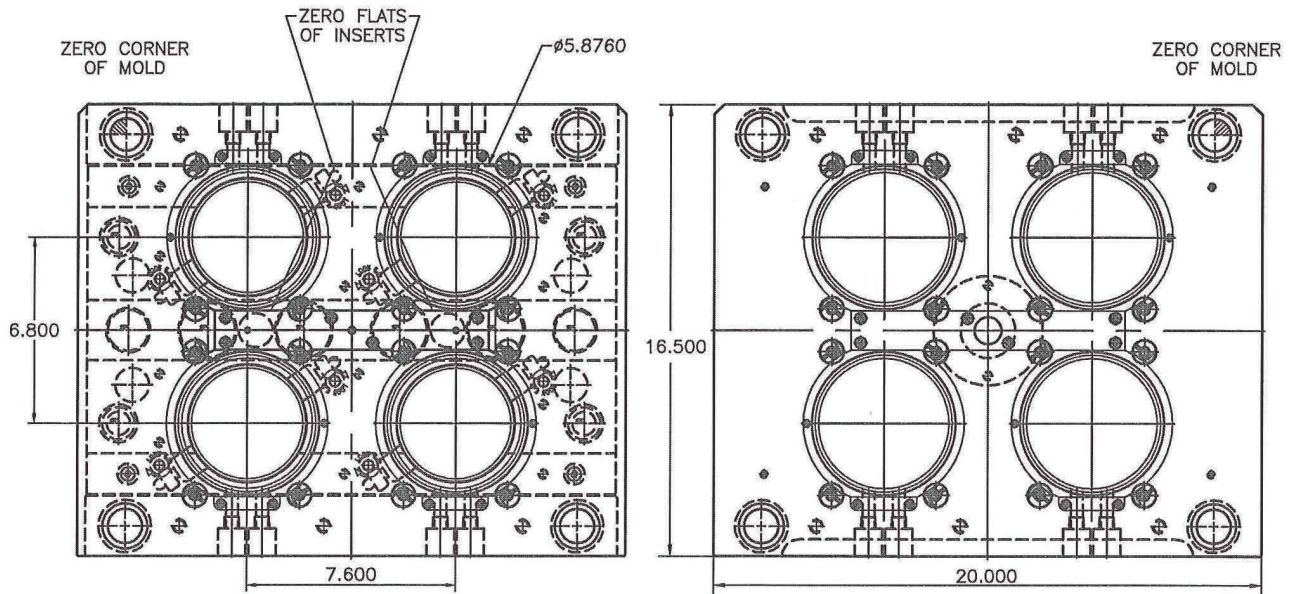

MULTI-POSITION MASTER FRAMES ARE SUPPLIED WITH SPI STANDARD KNOCKOUT LOCATIONS.
NON-STANDARD KNOCKOUT LOCATIONS WILL BE QUOTED UPON REQUEST.

WHEN ORDERING A MULTI-POSITION MASTER FRAME PLEASE SPECIFY: RUNNER SIZE;
RUNNER BLOCK HEIGHT; SPRUE BUSHING "R" & "O" DIM.; LOCATING RING TYP

STANDARD 4 POSITION MASTER FRAME

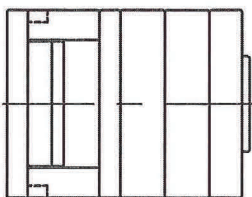

STYLE #	C	CC	H	S
RMF-0643	3	4.9375	10.375	1.312
RMF-0644	4	5.9375	11.375	2.312
RMF-0645	5	6.9375	12.375	3.312

6" EX4 Frame Components

ROUND MATE®

INSULATOR BOARD

OPTIONAL

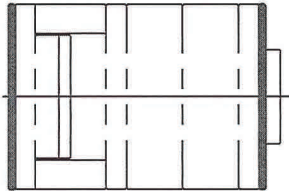

 "B" PLATE	 "A" PLATE 4.00 DIA.
RMC-6055	RMC-6054
USED WITH STANDARD CLAMP PLATE	

EXTENDED LOCATING RING

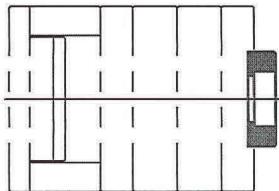

 1 1/8 3.990 DIA. 2 3/8 DIA. 7/32 2	 1 3.990 DIA. 2 3/8 DIA. 7/32 2
RMC-0073	RMC-0071
USED WITH INSULATOR BOARD	

LOCATING RING

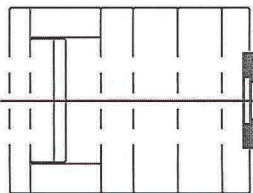

 17/32 3.990 DIA. 1.75 7/32 2	 4.331 DIA. 3.0 DIA. 17/32 2 4
RMC-0070	RMC-0072

RETAINER/LIFTER

 1.50	 ROUND MATE® 5.75 6mm HEX
RMC-0002	RMC-0006
2 SETS ARE SUPPLIED WITH EACH MASTER FRAME	

EJECTOR RETAINER WRENCH

 ROUND MATE® 10.25 6mm HEX
RMC-0007
1 PIECE SUPPLIED WITH EACH MASTER FRAME

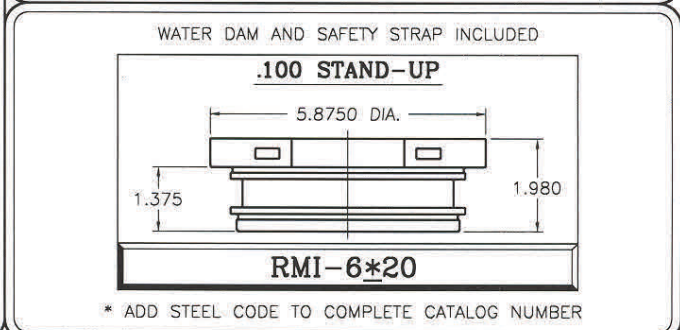
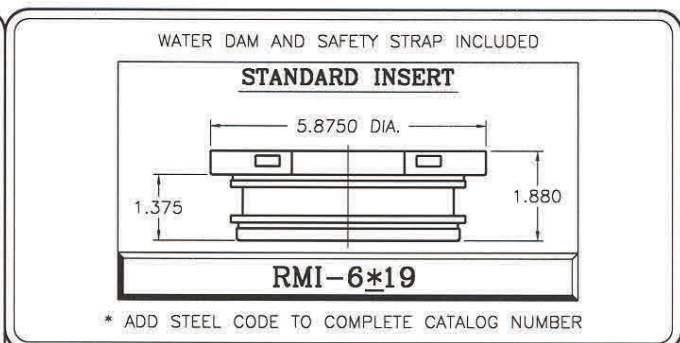
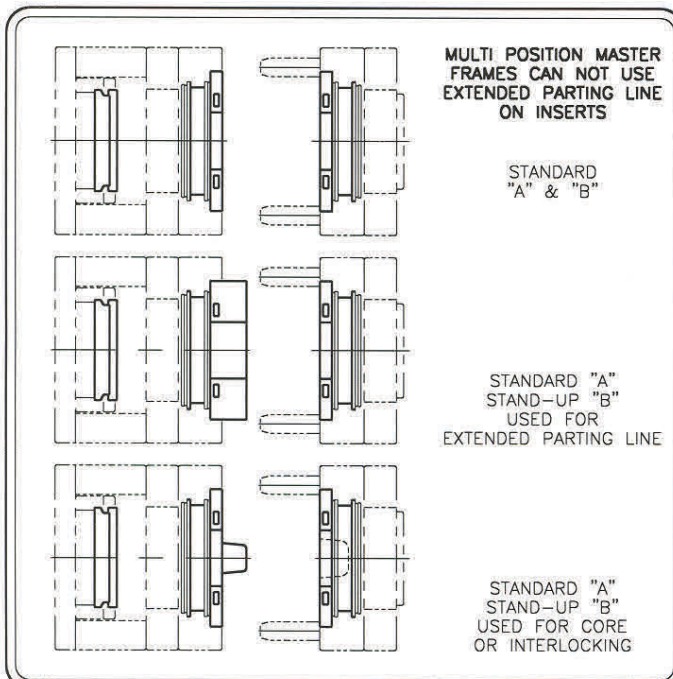

AVAILABLE STEEL

* CODE	STEEL
3	P-20 PRE-HARD 32/34 Rc
4	S-7 ANNEALED
5	H-13 ANNEALED
6	420SS ANNEALED
8	420SS PRE-HARD 32/35 Rc

* USE CODE NUMBER ABOVE TO COMPLETE CATALOG NUMBER FOR INSERTS.

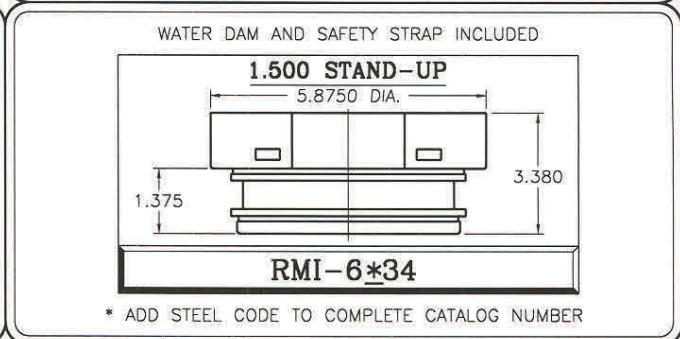
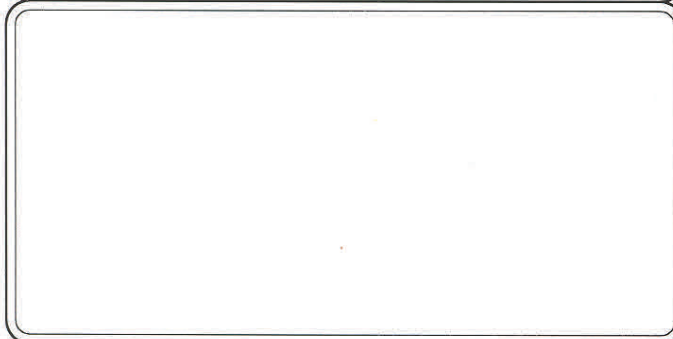
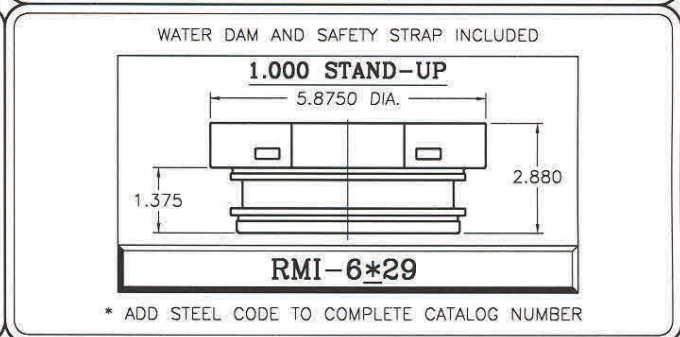
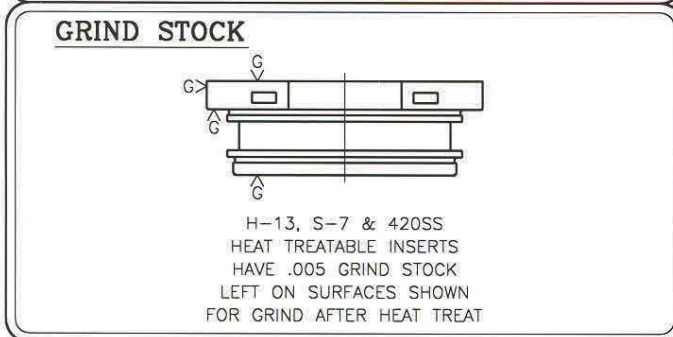
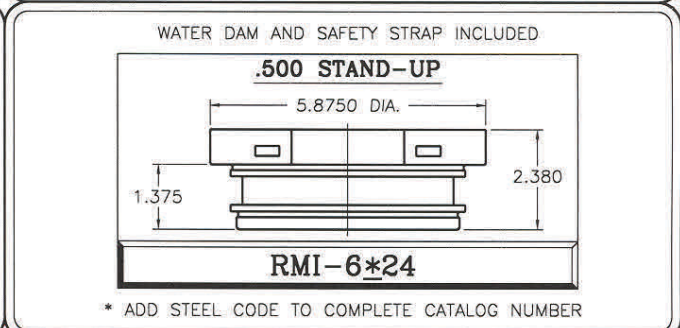

6" EX Insert Components

CORE RETAINER PLATE

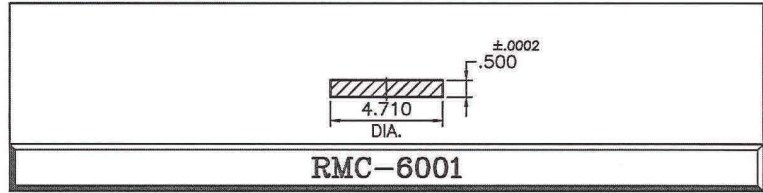
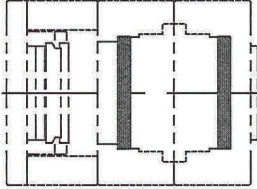

NOTE: MUST ALWAYS BE USED WITH INSERT.

MAT'L 4140

EJECTOR PLATE ASSEMBLY

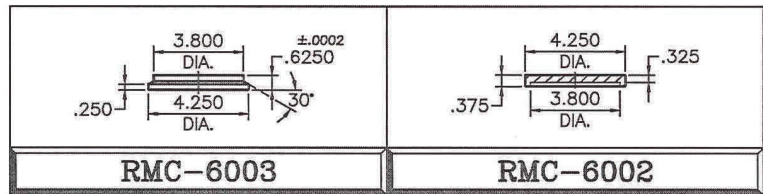
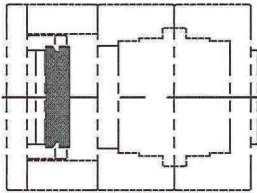

EJECTOR PLATE

EJECTOR RETAINER PLATE

MAT'L 4140

QUICK CONNECT EJECTOR PLATE

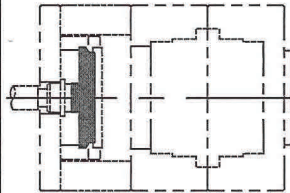

OPTIONAL

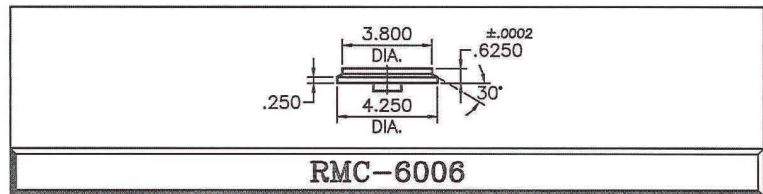

FOR USE WITH SINGLE POSITION MASTER FRAME

MAT'L 4140

QUICK EJECTOR CONNECT

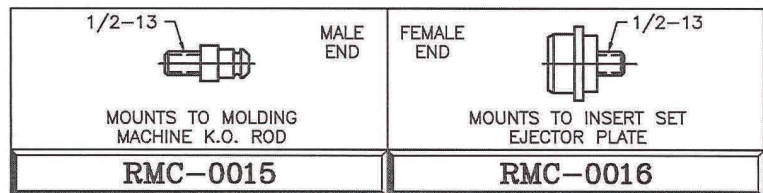
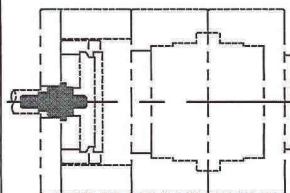

SLEEVE EJECTION CORE RETAINER PLATES

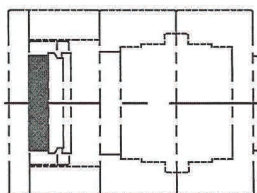



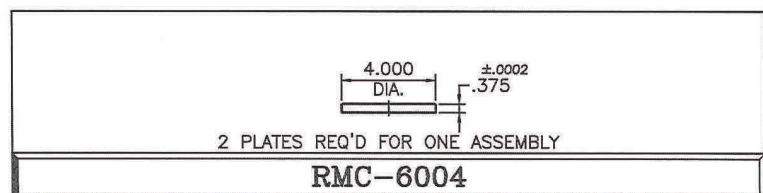

OPTIONAL

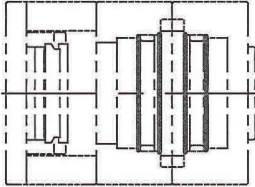

MAT'L 4140

O-RINGS



<p>O-RING SET FOR 4" INSERT</p>  <p>BUNA-N</p> <p>RMC-6015</p> <p>2 SETS ARE INCLUDED WITH INSERT SET</p>	<p>SET INCLUDES 2 O-RINGS FOR ONE INSERT</p> <p>VITON - HI TEMP</p> <p>RMC-6017</p> <p>ARE AVAILABLE UPON REQUEST</p>
<p>O-RING SET FOR 4" INSERT</p>  <p>BUNA-N</p> <p>RMC-6016</p> <p>ARE AVAILABLE UPON REQUEST</p>	<p>PACKAGE OF 10 O-RING SETS</p>  <p>VITON - HI TEMP</p> <p>RMC-6018</p> <p>ARE AVAILABLE UPON REQUEST</p>

SLEEVE EJECTION SUPPORT PILLAR

OPTIONAL

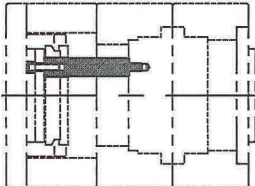

MOLD MAKER MAY TRIM SUPPORT PILLARS TO LENGTH FOR CUSTOM APPLICATIONS

SET SCREW INCLUDED

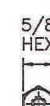
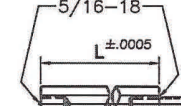
 <p>5/8 HEX</p> <p>"L"=3.1270</p> <p>RMC-0022</p> <p>"L"=3.6270</p> <p>RMC-0023</p>	 <p>5/16-18 L ±.0005</p> <p>"L"=4.6270</p> <p>RMC-0024</p> <p>"L"=5.1270</p> <p>RMC-0025</p> <p>"L"=5.6270</p> <p>RMC-0026</p>
--	---

MAT'L 1144

WATER BAFFLE (Packs of 10)

NYLON PLASTIC, NOT FOR HIGH TEMPERATURE APPLICATIONS

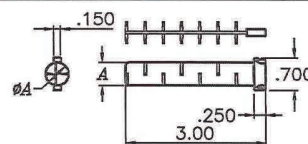
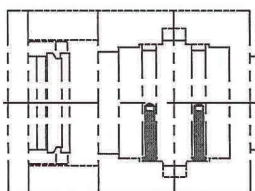

A DIM.	FOR USE WITH 3", 4" AND 6" ROUND MATE INSERTS
.312	RMC-0080
.500	RMC-0081

6" EX Insert Components

ROUND MATE®

WATER DAM

1 SUPPLIED WITH EACH INSERT

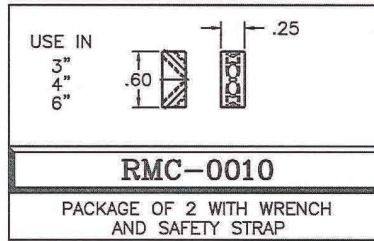
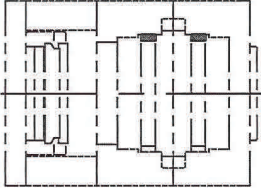

MAT'L 416SS

SAFETY STRAP

1 SUPPLIED WITH EACH INSERT

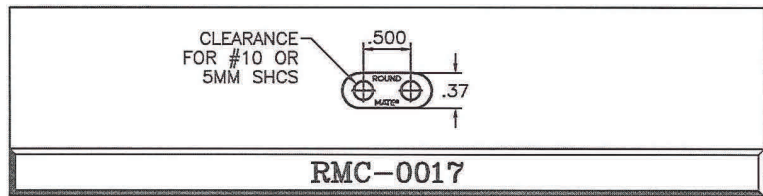
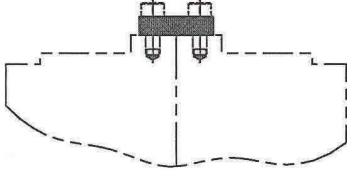

PACKAGE OF 10

MAT'L NYLON

RETURN PIN EXTENSIONS

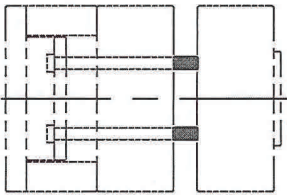

OPTIONAL

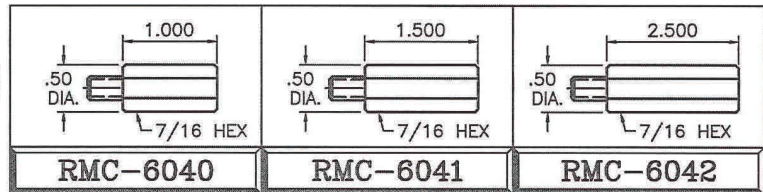

MAT'L 4142

FITTED STORAGE BOX

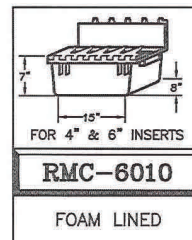
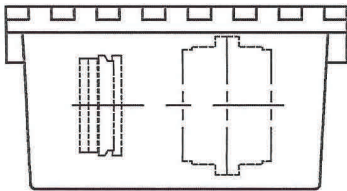

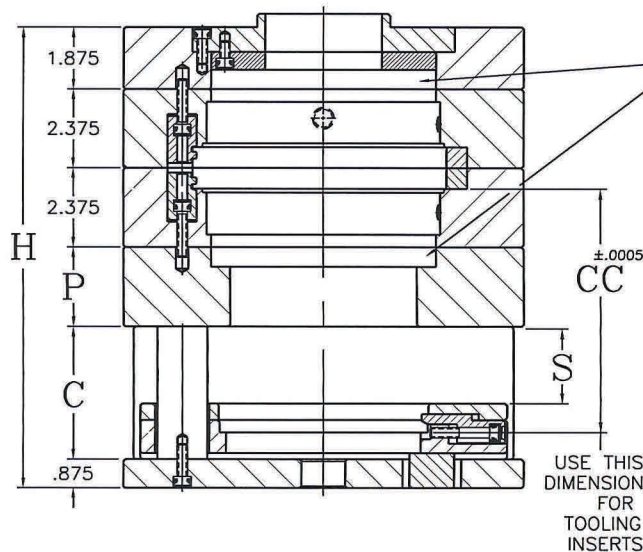
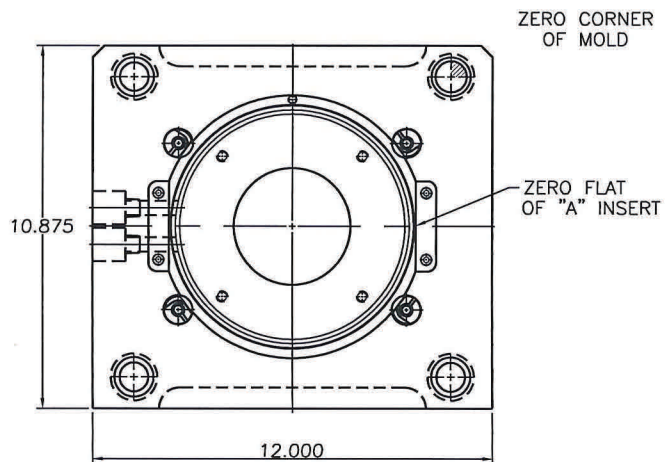
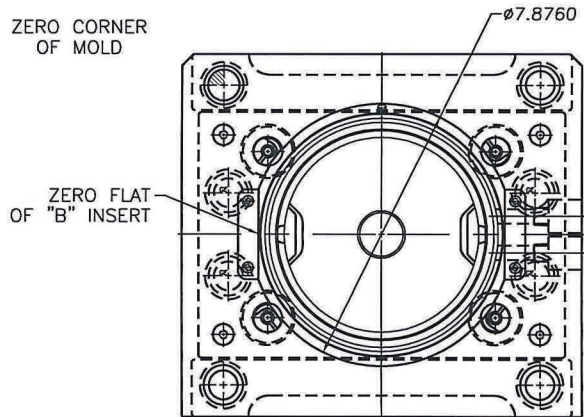

NOTE: THE EX OPTION WAS CREATED TO MAKE THE INSERT SET EXPANDABLE TO THE MULTI POSITION MASTER FRAME. THE MULTI POSITION MASTER FRAME REQUIRES CORE RETAINER PLATES ON THE BACK OF BOTH INSERTS. THIS EX OPTION ALLOWS SINGLE POSITION INSERT SETS TO BE VERTICALLY EXPANDABLE TO THE MULTI POSITION MASTER FRAMES BY UTILIZING THE ADDITIONAL CORE RETAINER PLATES.

STANDARD MASTER FRAME WITH EXPANDABLE OPTION (EX)

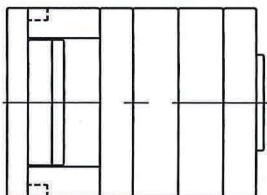

STYLE #	C	CC	H	P	S
RMF-0813-X	3	5.3125	11.875	1.375	1.312
RMF-0814-X	4	7.3125	13.875	2.375	2.312
RMF-0815-X	5	8.3125	14.875	2.375	3.312

8" EX Frame Components

INSULATOR BOARD

OPTIONAL

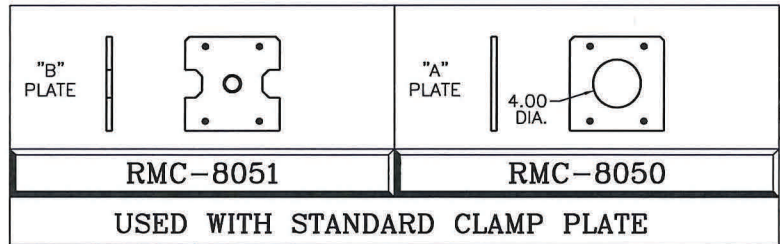
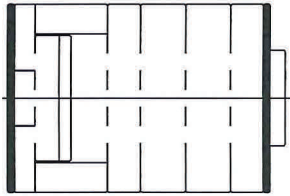

EXTENDED LOCATING RING

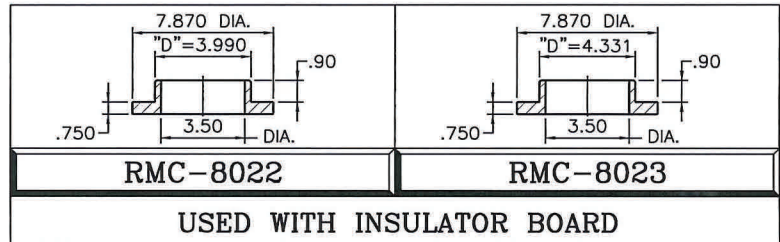
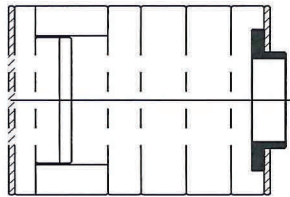

MOUNTING SCREWS INCLUDED

MAT'L 4140

LOCATING RING

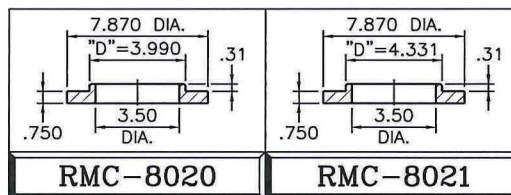
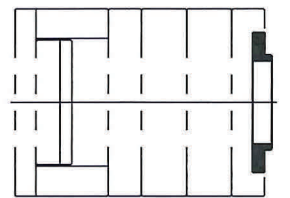

MOUNTING SCREWS INCLUDED

MAT'L 4140

EXTENDED NOZZLE DISC

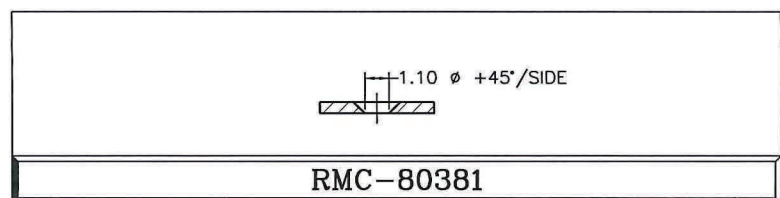
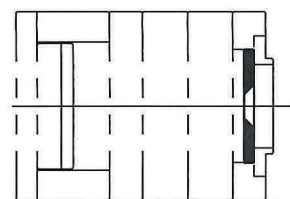

MOUNTING SCREWS INCLUDED

MAT'L 6150 H.T.

EJECTOR K.O. MOUNTING BLOCK

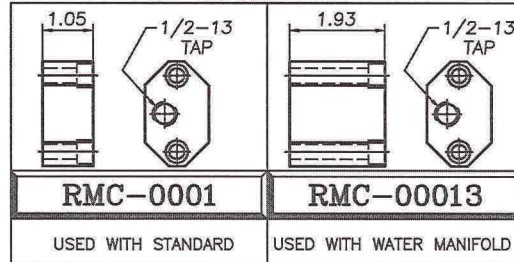
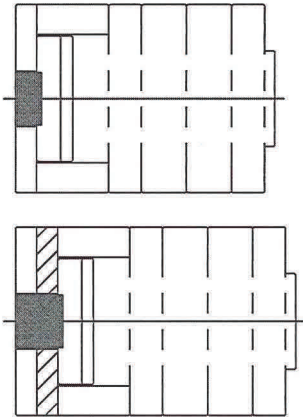

PACKAGE OF 2 2 K.O. BLOCKS INCLUDED WITH MASTER FRAME MAT'L 4140

RETAINER/LIFTER - EJECTOR RETAINER WRENCH

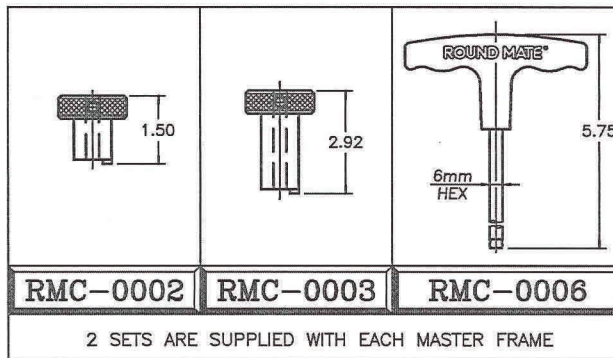

ROUND MATE®

ZERO CORNER
OF MOLD

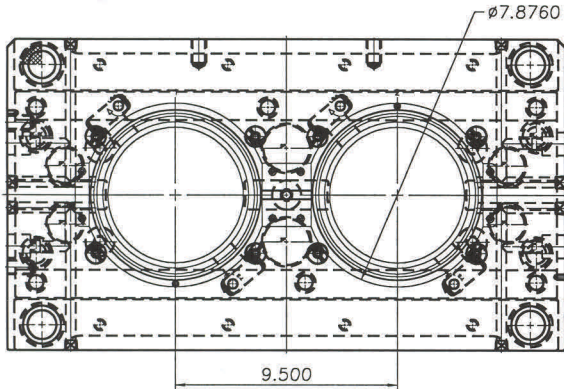

ZERO CORNER
OF MOLD

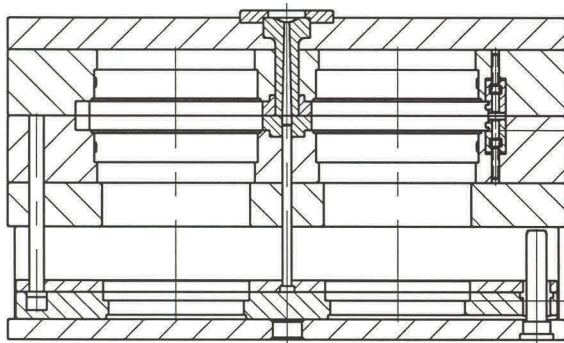
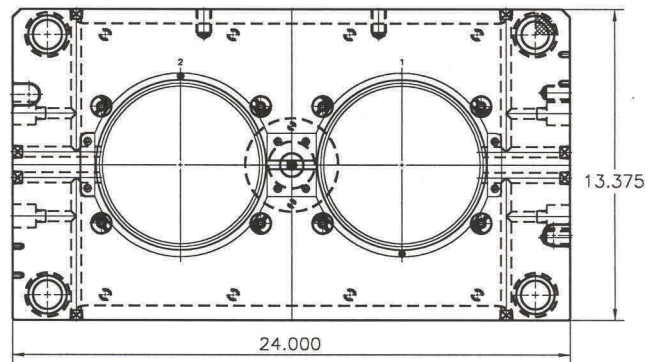

USE THIS
DIMENSION
FOR
TOOLING
INSERTS

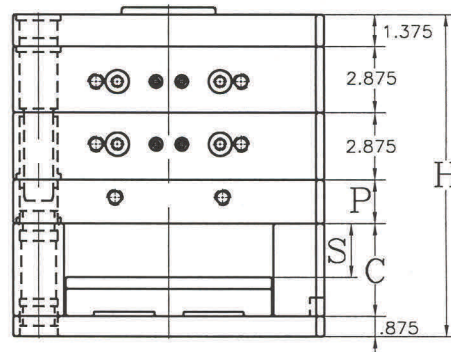

MULTI-POSITION MASTER FRAMES ARE SUPPLIED WITH SPI STANDARD KNOCKOUT LOCATIONS.
NON-STANDARD KNOCKOUT LOCATIONS WILL BE QUOTED UPON REQUEST.

WHEN ORDERING A MULTI-POSITION MASTER FRAME PLEASE SPECIFY: RUNNER SIZE;
RUNNER BLOCK HEIGHT; SPRUE BUSHING "R" & "O" DIM.; LOCATING RING TYP

STANDARD 2 POSITION MASTER FRAME

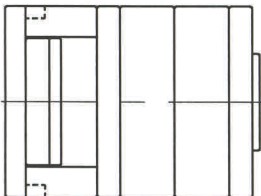

STYLE #	C	CC	H	P	S
RMF-0823	3	5.3125	11.875	.875	1.312
RMF-0824	4	7.3125	13.875	1.875	2.312
RMF-0825	5	8.3125	14.875	1.875	3.312

8" EX2 Frame Components

ROUND MATE®

INSULATOR BOARD OPTIONAL

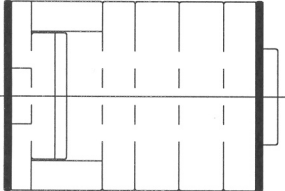

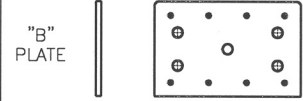
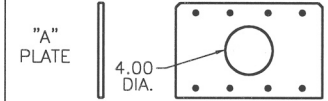
 <p>"B" PLATE</p>	 <p>"A" PLATE 4.00 DIA.</p>
RMC-8053	RMC-8052
USED WITH STANDARD CLAMP PLATE	

EXTENDED LOCATING RING

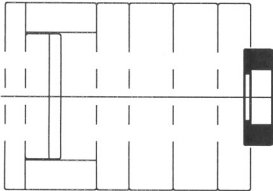

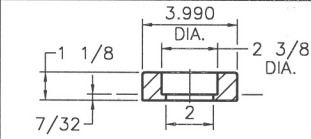
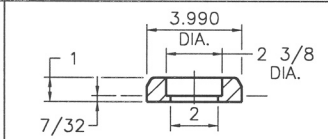
	
RMC-0073	RMC-0071
USED WITH INSULATOR BOARD	

LOCATING RING

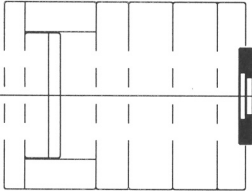

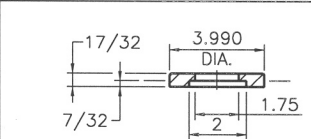
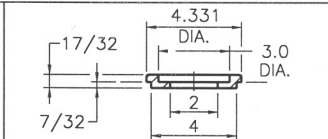
	
RMC-0070	RMC-0072

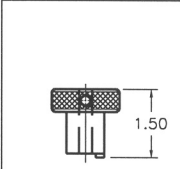
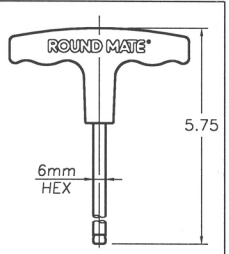
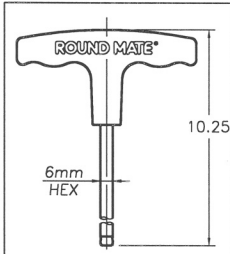
<p>RETAINER/LIFTER</p>  <p>RMC-0002</p>	<p>EJECTOR RETAINER WRENCH</p>  <p>RMC-0006</p>
<p>2 SETS ARE SUPPLIED WITH EACH MASTER FRAME</p>	
 <p>RMC-0007</p>	
<p>1 PIECE SUPPLIED WITH EACH MASTER FRAME</p>	

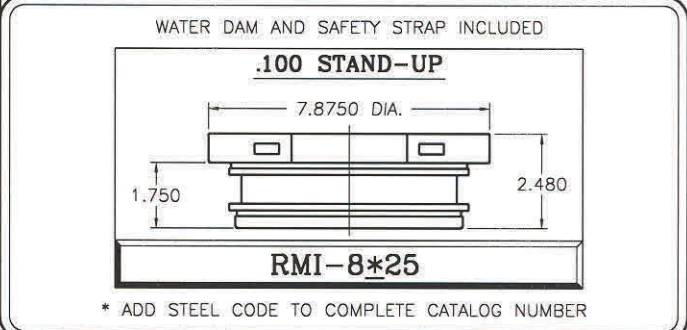
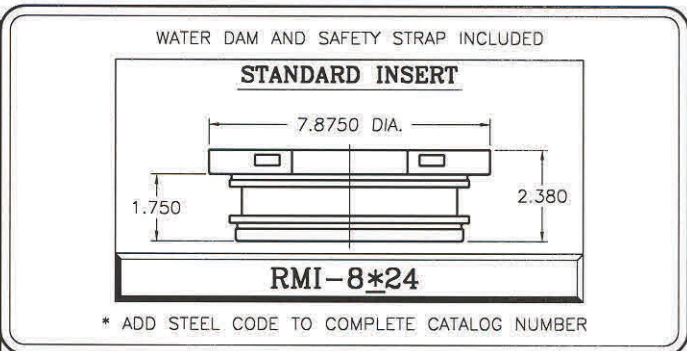
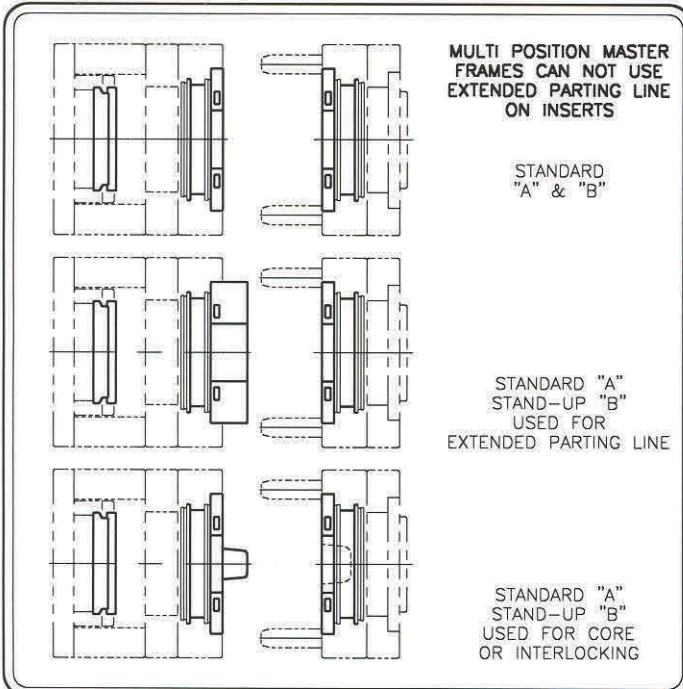

AVAILABLE STEEL

* CODE	STEEL
3	P-20 PRE-HARD 32/34 Rc
4	S-7 ANNEALED
5	H-13 ANNEALED
6	420SS ANNEALED
8	420SS PRE-HARD 32/35 Rc

* USE CODE NUMBER ABOVE TO COMPLETE CATALOG NUMBER FOR INSERTS.

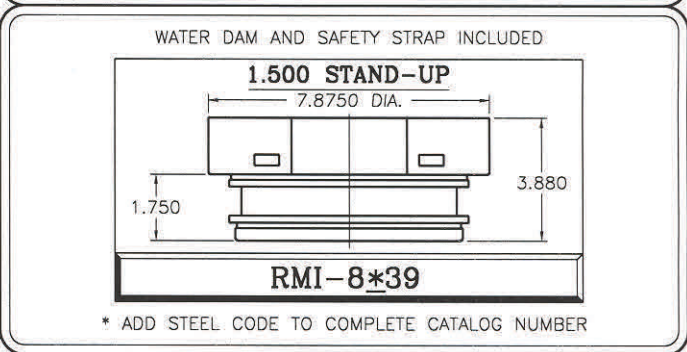
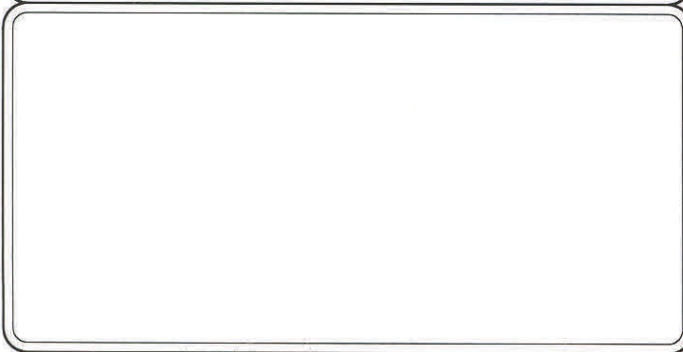
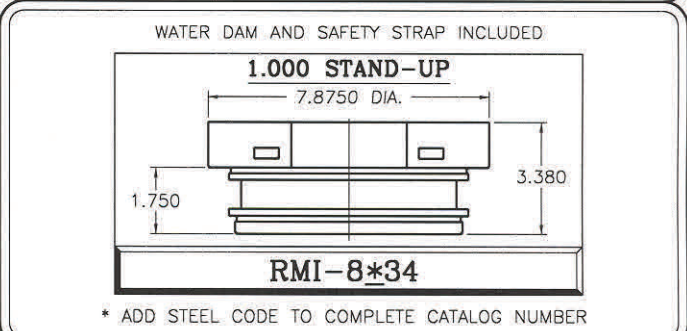
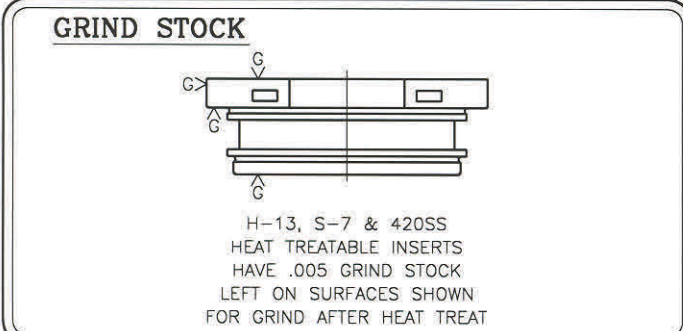
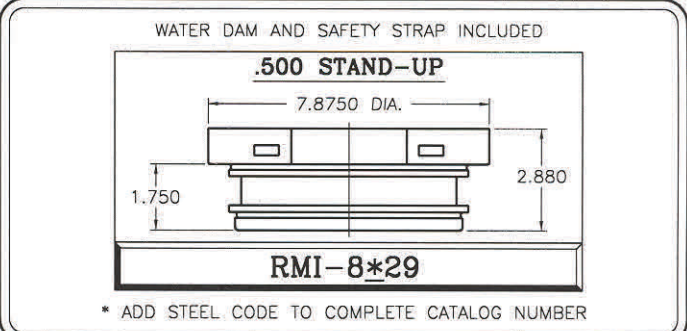

8" EX Insert Components

CORE RETAINER PLATE

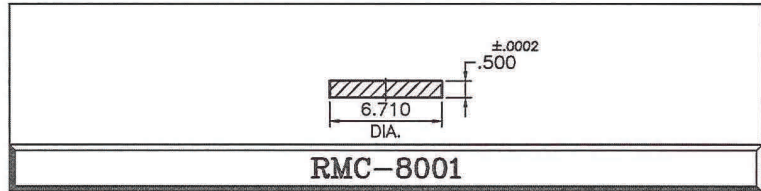
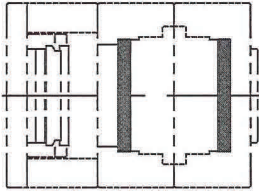

NOTE: MUST ALWAYS BE USED WITH INSERT.

MAT'L 4140

EJECTOR PLATE ASSEMBLY

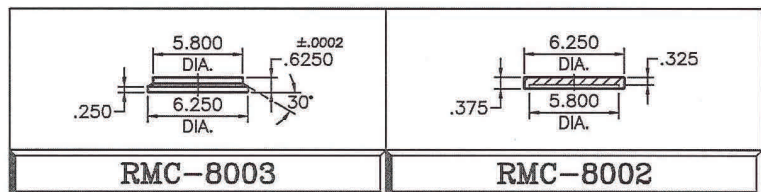
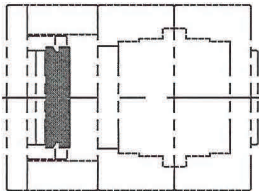

EJECTOR PLATE

EJECTOR RETAINER PLATE

MAT'L 4140

QUICK CONNECT EJECTOR PLATE

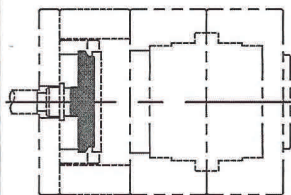

OPTIONAL

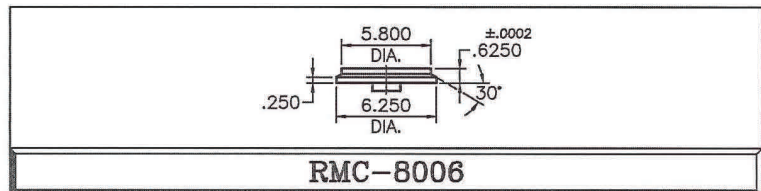

FOR USE WITH **SINGLE POSITION** MASTER FRAME

MAT'L 4140

QUICK EJECTOR CONNECT

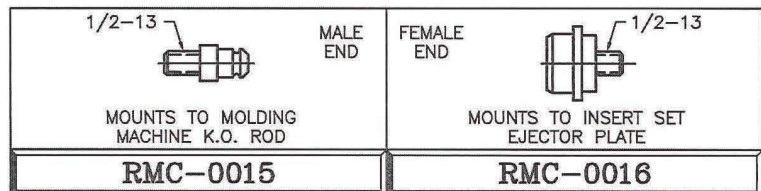
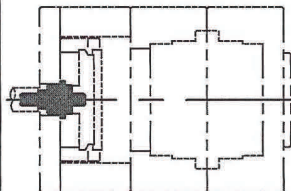

SLEEVE EJECTION CORE RETAINER PLATES

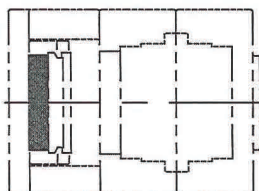



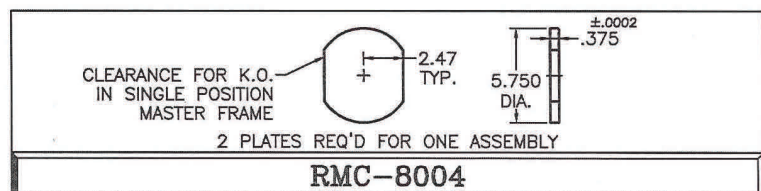

OPTIONAL

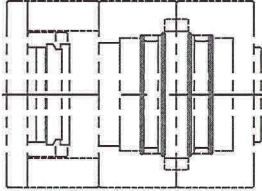

MAT'L 4140

O-RINGS



O-RING SET FOR 4" INSERT  BUNA-N	SET INCLUDES 2 O-RINGS FOR ONE INSERT	O-RING SET FOR 4" INSERT  VITON - HI TEMP	SET INCLUDES 2 O-RINGS FOR ONE INSERT
RMC-8015		RMC-8017	
2 SETS ARE INCLUDED WITH INSERT SET		ARE AVAILABLE UPON REQUEST	
O-RING SET FOR 4" INSERT  BUNA-N	PACKAGE OF 10 O-RING SETS	O-RING SET FOR 4" INSERT  VITON - HI TEMP	PACKAGE OF 4 O-RING SETS
RMC-8016		RMC-8018	
ARE AVAILABLE UPON REQUEST		ARE AVAILABLE UPON REQUEST	

SLEEVE EJECTION SUPPORT PILLAR

OPTIONAL

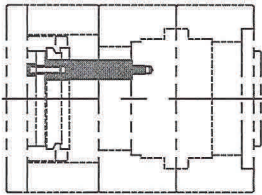

MOLD MAKER MAY TRIM SUPPORT PILLARS TO LENGTH FOR CUSTOM APPLICATIONS

SET SCREW INCLUDED

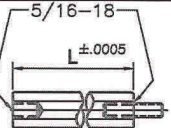
	
"L"=3.6270	"L"=5.6270
RMC-0023	RMC-0026
"L"=4.6270	"L"=6.1270
RMC-0024	RMC-0027
"L"=5.1270	"L"=6.6270
RMC-0025	RMC-0028

MAT'L 1144

WATER BAFFLE (Packs of 10)

NYLON PLASTIC, NOT FOR HIGH TEMPERATURE APPLICATIONS

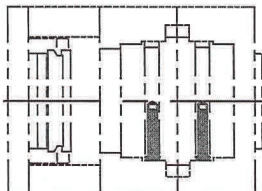

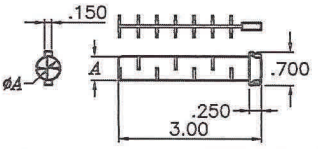
	
A DIM.	FOR USE WITH 3", 4" AND 6" ROUND MATE INSERTS
.312	RMC-0080
.500	RMC-0081

8" EX Insert Components

ROUND MATE®

WATER DAM

1 SUPPLIED WITH EACH INSERT

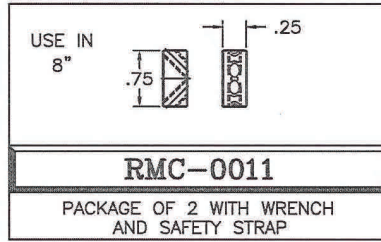
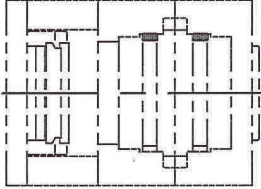

MAT'L 416SS

SAFETY STRAP

1 SUPPLIED WITH EACH INSERT

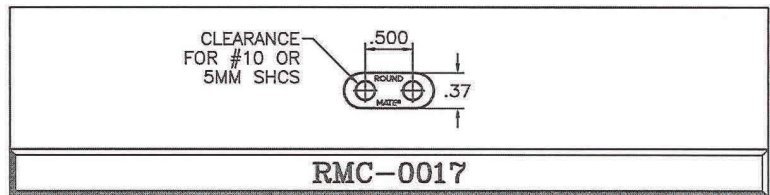
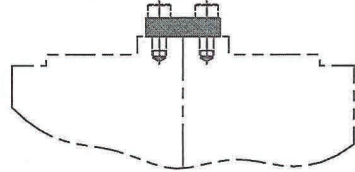

PACKAGE OF 10

MAT'L NYLON

RETURN PIN EXTENSIONS

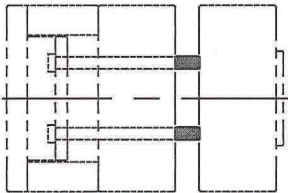

OPTIONAL

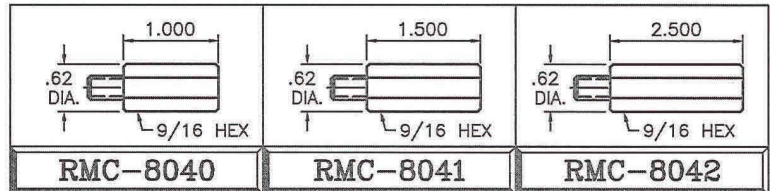

MAT'L 4142

FITTED STORAGE BOX

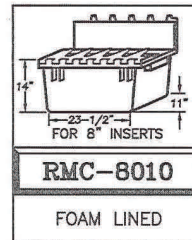
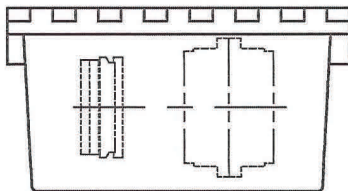

SUPPORT PILLAR

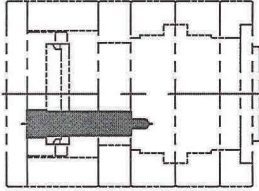

MOLD MAKER MAY TRIM
SUPPORT PILLARS TO
LENGTH FOR CUSTOM
APPLICATIONS

CUSTOM LENGTHS ARE
AVAILABLE, CALL FOR QUOTE

SET SCREW INCLUDED

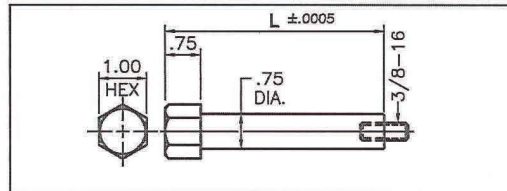

"L"=5.8770	"L"=6.8770
RMC-8061	RMC-8063
"L"=6.3770	"L"=7.3770
RMC-8062	RMC-8064